



WATCHMAN®
ANYWHERE

INSTALLATION
INSTRUCTIONS

For the most recent version please visit
www.watchmananywhere.com

POWERED BY KINGSPAN SENSOR

READ FULLY BEFORE INSTALLATION AND USE

1 CHECK TANK IS LEVEL & GSM / GPRS COVERAGE

2 TANK PREPARATION

3 FITTING BASE

4 CAPTURE TANK DETAILS & FILL IN THE CARD

5 INSTALL THE UNIT

6 ACTIVATE THE UNIT

7 REGISTER ONLINE

PLEASE NOTE: All installation diagrams reference a banded oil tank. However all single skin tanks are suitable for installation as well.

TOOLS REQUIRED:

- 32mm Hole Saw
- Star Head Screwdriver
- Electric Drill

IMPORTANT

Under no circumstances shall the sellers be responsible for any loss of data or income, or any special, incidental, consequential or indirect damages howsoever caused when using or installing this equipment. The contents of this document are provided as is, and are likely to change without notice.

WARNING

Suitable for use in tanks for the storage of diesel fuel, kerosene, and gas oil types A2, C1, C2 and D as defined by BS 2869 also biodiesel grades up to B5 produced in accordance with EN14214. Check with the manufacturer and / or supplier before using with any other fluids. Ensure that all local guidelines are adhered to before fitting the unit to any tank.

Please refer to the Terms and Conditions on www.watchmananywhere.com

1 CHECK TANK IS LEVEL AND GSM / GPRS COVERAGE

- Ensure before you start that the tank is positioned on a level surface.
- Check that the area in which you are installing the unit has a GSM\GPRS signal.

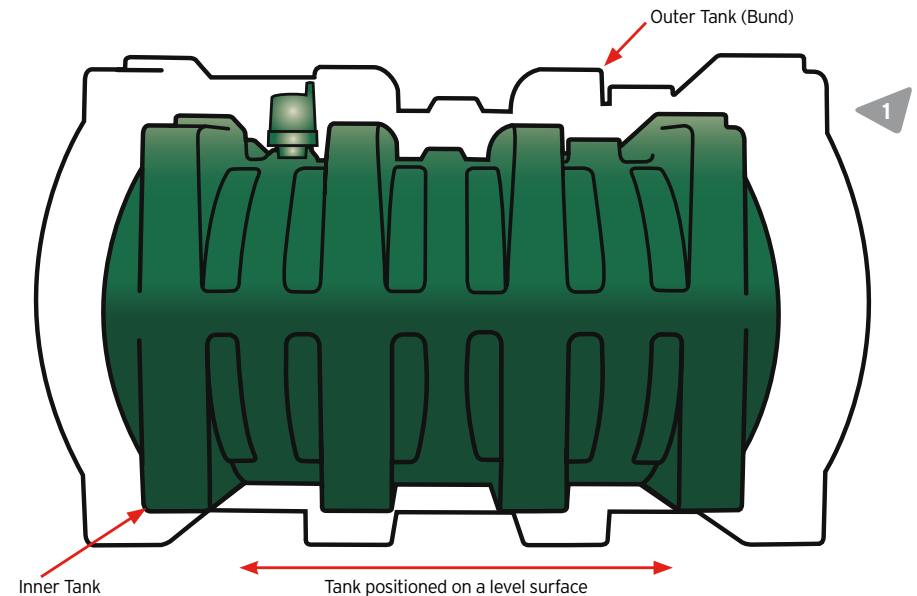

2 TANK PREPARATION

- Choose a suitable position for Watchman Anywhere - choose a flat level point that is at the same level and no higher than any opening at the top of the tank (filling point etc.).
- Only drill the tank where permissible. (See Picture 2)
(Please consult the tank manufacturer before drilling tank).

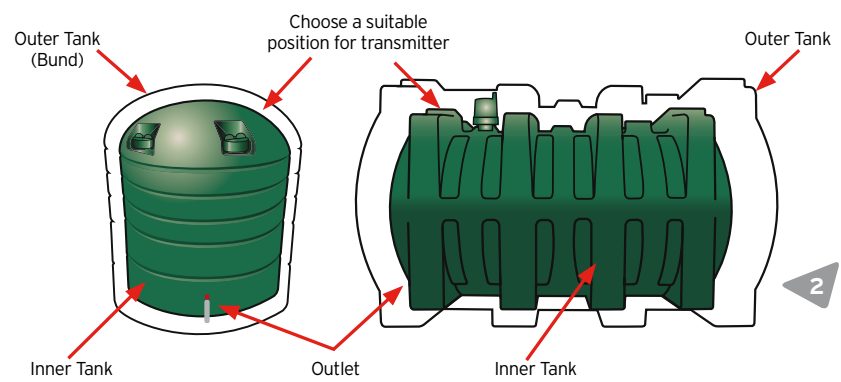

- Before choosing the final position of the Watchman Anywhere ensure that the space beneath the Watchman Anywhere unit is free of any obstacles and that the ultrasonic beam path is clear of obstructions. Ensure that the unit is fitted to the inner tank if it is a bunded tank. (See Picture 3)

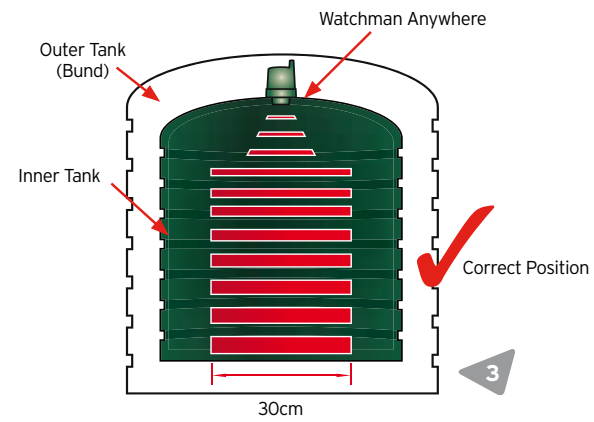

- The Watchman Anywhere can't sit at an angle as this gives an incorrect level. Take care not to choose an area on which water could gather i.e. a dent / depression or a position directly above any restricted area inside the tank. (See Picture 4)

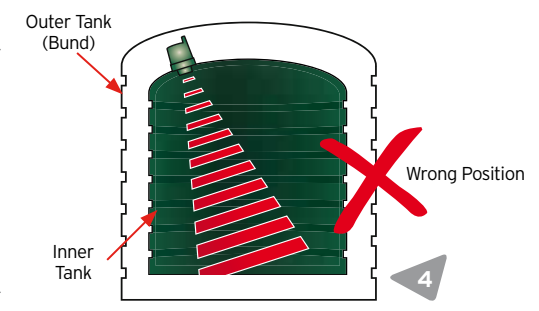

- For tanks with window corrugations please ensure that the Watchman Anywhere is not positioned above or within 15 cm of the area of the WINDOW or the edge of the tank. (See Picture 5)
- Ensure that the sonic path is clear to the bottom of the tank. (See Picture 3)

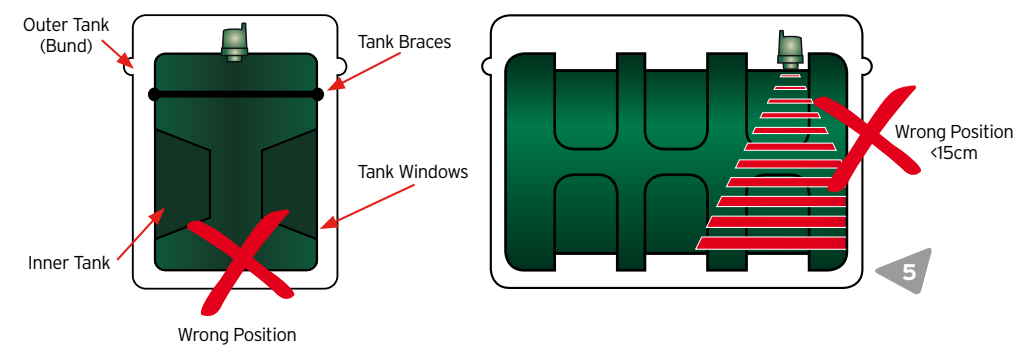

- Drill a hole in the place that you have selected on the tank's top surface using a 32mm hole-saw. (See Picture 6)
- If in doubt please consult the tank manufacturer before drilling the tank.

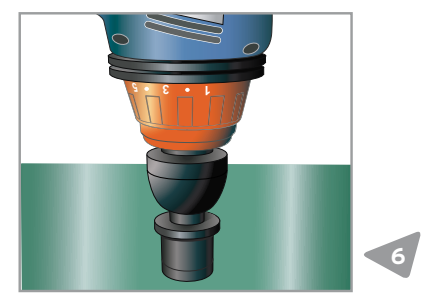

3 FITTING BASE

- Insert Watchman Anywhere base ensuring the weather seal is securely in place. **(Picture 7)**
- Tighten the Watchman Anywhere base on to the tank with 2 stainless steel self-tapping, counter sunk screws supplied. Do not over tighten! **(Picture 8)**



4 CAPTURE TANK DETAILS & FILL IN THE REGISTRATION CARD

- Accurately measure the Sonic height (Distance from the bottom of the tank to the top of Watchman base).

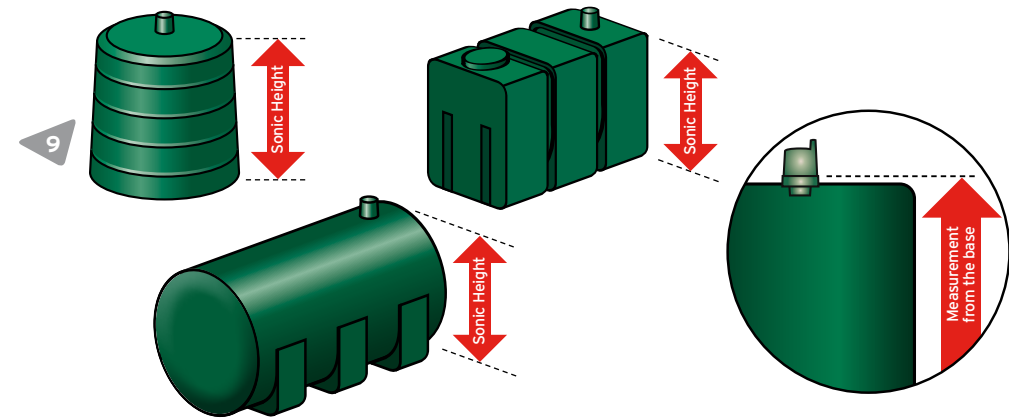

- Record the sonic height and other required information on the enclosed card.

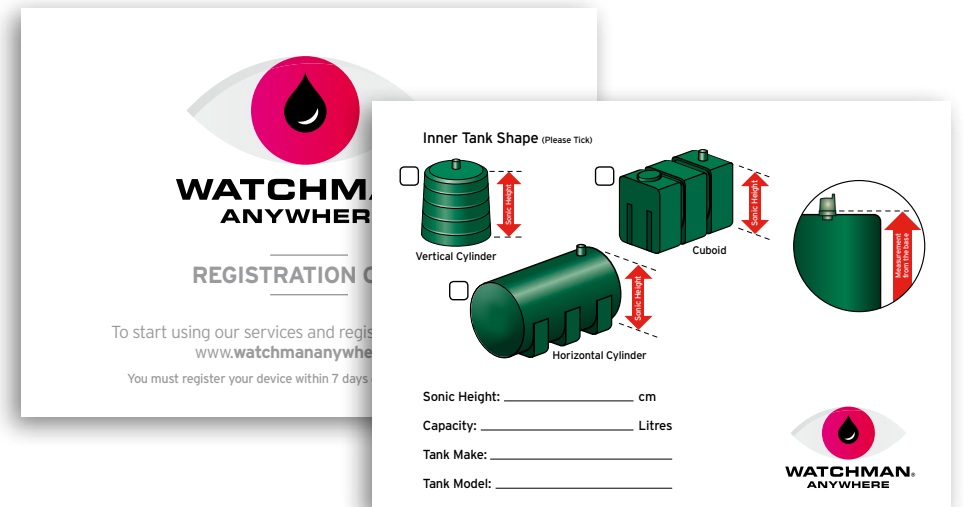

5 INSTALL THE UNIT

Screw the Watchman Anywhere into the base. Ensure the unit is vertical on top of the tank and level. Ensure that the unit is screwed correctly into the base and that the threads have not crossed, to give a secure seal.

6 ACTIVATE THE UNIT

- To activate the Watchman Anywhere the following procedure must be carried out prior to leaving the site:
 - To put the device into install mode hold the magnet on the red hot spot until you hear the beep. **(See Picture 10)**. The Watchman Anywhere should make a short beep sound to confirm that the unit is active.
 - After a 10 second pause there will be a series of short beeps, spaced approx. 1 second apart.
 - The Watchman Anywhere will stay active for about 15 minutes, then enter sleep mode.
 - When the unit has been registered online as per point 7 it will take up to 24 hrs for levels to be sent to your account. If the levels are required immediately or before 24 hours, register online as per step 7 and return and activate the unit again as per step 6.



7 REGISTER ONLINE

For registration visit the website www.watchmananywhere.com and click on the register button where you will be guided through the simple registration process. Please remember to have your completed tank registration card to hand.

You must register your device within 7 days of installation on tank.
In the event that this has not happened revert back to Step 6.

GUARANTEE

The Watchman Anywhere has a warranty period of 1 year. For each product accepted by Kingspan Environmental as warrantable, Kingspan Environmental will rework or replace the product and return to the customer at Kingspan Environmental's expense. If the warranty void seal is broken the unit warranty becomes void.

Kingspan Environmental will NOT warrant products that have been:

- Used outside the functional and environmental conditions for which they were designed.
- Physically abused, incorrectly handled / installed or damaged in transit.
- Despatched from Kingspan Environmental more than 1 year previously.
- Returned to Kingspan Environmental in a form other than in which they were originally supplied.
- Subject to 'Act of God', e.g.: lightning strike, flood or any other catastrophic event beyond Kingspan Environmental's control.

Any Sensor product deemed damaged by the customer shall be returned to Kingspan Environmental's facility at the customer's expense.

Kingspan Environmental shall not be liable for any costs in relation to the returned products.

The purchase invoice and a description issue should be joined with the faulty product. The product should be returned to your supplier or directly to the following address:

Kingspan Environmental Ltd

Sensor Systems Team
180 Gilford Road
Portadown
Co. Armagh
Northern Ireland
BT63 5LF

SPECIFICATIONS

CHARACTERISTICS	TRANSMITTER
Dimensions	101mm (W) x 93mm (L) x 150mm (H) ±1mm
Weight:	520g (including batteries)
Housing material:	UV Stabilized Polypropylene (compatible with Oil)
Operating temperature:	-10°C to 45°C (Note 1)
Storage temperature:	-25°C to 45°C (Note 1)
Altitude range:	<2Km above sea level
Environmental Protection IP67:	- Outdoors
Radio frequency:	Tri-Band GSM\GPRS (Quad band available)
Gauge Type:	Ultrasonic
Ultrasonic range:	>12cm to <3M (Note 2)
Ultrasonic resolution:	+/- 5cm
Power requirements:	4 of Type C LR14 Alkaline 1.5V (fitted). Battery replacement available from www.KEpartshop.com
Battery life:	Approximately 3 Years (Note 4)
Humidity range:	15% - 95%

Note 1: Storage and operation above 20°C may reduce battery life.

Note 2: Based on a measurement to a flat liquid target of size 30cm².

Note 3: Suitable for use in tanks for the storage of water diesel fuel, kerosene, AdBlue, gas oil types A2, C1, C2 and D as defined by BS2869.

Note 4: Based on 8 GPRS messages per Month in standard configuration at a location with adequate GPRS coverage.

KIT CONTENTS

1. Watchman Anywhere Unit
2. Base, Gasket & Screws
3. Magnet
4. Registration Card
5. Installation Instructions

FAQs & FURTHER INFORMATION

All FAQ's will be answered at www.watchmananywhere.com

Declaration: This apparatus is designed to: Not give rise to physical injury or other harm due to contact. Not to produce excessive surface temperatures, infrared, electromagnetic, ionising radiation. To have no non-electrical dangers. When used in accordance with these user and installation instructions.

Warning: If the equipment is likely to come in to contact with aggressive substances, then it is the responsibility of the user to take suitable precautions that prevent it from being adversely affected, thus ensuring that the type of protection is not compromised. Aggressive substances; - e.g. liquids or gases that may attack metals, or solvents that may affect polymeric materials.

Supplied by Kingspan Environmental Ltd
180 Gilford Road, Portadown, Co. Armagh,
Northern Ireland, BT63 5LF.

Safety Information

Do not replace in a potentially explosive atmosphere. Periodically check that the unit is intact and securely fastened to the tank.

Check with the manufacturer on the chemical compatibility prior to use. Do not attempt to repair this equipment. It must be returned to the manufacturer for repair.

Warning! Electrostatic hazard!

Clean only with damp cloth.

Use only C-type batteries.

Not suitable for pressurised containers.

Use on tanks vented to atmosphere.

Warranty: 1 year.

FOR SUPPORT VISIT:
www.watchmananywhere.com

© Kingspan Environmental Ltd 01-05-2010 TMG



CONTACT



WATCHMAN®
ANYWHERE

Please visit our website:

www.watchmananywhere.com

Kingspan Environmental Ltd
Sensor Systems Team
180 Gilford Road, Portadown, Co. Armagh,
Northern Ireland BT63 5LF.

Sensor is part of Kingspan Environmental

